

scala rider®

Q-solo™



Manual



INDEX

IMPORTANT:





This is version 1.0 of the User Manual. Please note, that our manual is periodically updated on the Cardo website to include the very latest features and functions of your new scala rider.

- 1 INTRODUCTION
- 2 CHARGING THE SCALA RIDER
- 3 GETTING STARTED: 3.1 STATUS LIGHTS, 3.2 GENERAL FUNCTIONS, 3.3 VOX ACTIVATION
- 4 PAIRING AND USING A MOBILE PHONE, GPS DEVICE OR ANY MUSIC PLAYERS:
 - 4.1 PAIRING BLUETOOTH, 4.2 MAKING AND RECEIVING PHONE CALLS, 4.3 LISTENING TO MUSIC VIA A2DP
- 5 TROUBLESHOOTING
- 6 SUPPORT

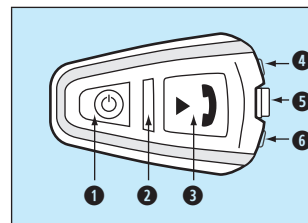
1 INTRODUCTION

Thank you for choosing the scala rider Q-solo Bluetooth® headset for motorcycle helmets. This manual will help you set up, configure and operate it.



1. Power Button 
2. LED Indicator
3. Music / Mobile Button 
4. Volume Up 
5. Charging 
6. Volume Down 

2 CHARGING THE SCALA RIDER

Make sure that your scala rider is fully charged for at least 4 hours before initial use.

Charging with a 5v wall charger is faster than charging with a computer USB port.

- RED LED ON – Charging
- RED LED OFF – Charging complete



The scala rider Q-solo is waterproof and dustproof. However, when in use, the USB silicone cover should be kept tightly closed to prevent moisture from entering the unit.

3 GETTING STARTED

3.1 STATUS LIGHTS

None	scala rider is OFF
The BLUE LED flashes once every 3 seconds	Standby mode. No active audio sources
The BLUE LED flashes twice every 3 seconds	Active mode – Call in progress / music or other audio source is ON
The RED LED flashes once every 3 seconds	Standby mode – Battery is low
The RED LED flashes twice every 3 seconds	Active mode – Battery is low
Solid RED	Charging

3.2 GENERAL FUNCTIONS

Power ON / OFF	Press for 2 seconds ON: 3 BLUE flashes + Ascending tone OFF: 3 RED flashes + Descending tone
Volume	Tap or to adjust and set volume of current audio source
Mute	Tap and simultaneously
Battery Check	In Standby, press for 2 seconds: • BLUE LED = Full charge • PURPLE LED = Half charge • RED LED = Almost empty

3.3 VOX ACTIVATION

Your scala rider offers a voice operated feature for hands-free operation.

Answer a call	Speak any word loudly into the microphone
Reject a call	Remain silent for about 15 seconds

PAIRING AND USING A MOBILE PHONE, GPS DEVICE OR ANY MUSIC PLAYER

- 4** To connect your scala rider to a *Bluetooth* device you must first pair them. Once paired, they will automatically recognize each other whenever they are within range (10m / 33ft).
Your scala rider has *Bluetooth* channel for connecting to a mobile phone, GPS device and a music player with A2DP.



4.1 PAIRING BLUETOOTH

1. Make sure *Bluetooth* is enabled on your phone/GPS/MP3 player.
2. Check the scala rider is in Standby mode (single LED flashes every 3 seconds).
3. Press for at least 5 seconds until the **BLUE** LED flashes once every 3 seconds
4. Search for *Bluetooth* devices on your phone/GPS/MP3 player by following the device's instructions.
5. After a few seconds the device will list "scala rider **Q-solo**". **Select it.**
6. If prompted for a PIN or Passkey, enter 0000 (four zeros).
7. The device will confirm that pairing has succeeded and **PURPLE** will flash for 2 seconds
8. If pairing is not completed within 2 minutes, the scala rider will return to Standby mode.

NOTES:

- Not all *Bluetooth* mobile phones can broadcast *Bluetooth* Stereo music (A2DP), even if the phone has a music player function. Consult your mobile phone's User Manual for more information.
- Not all *Bluetooth* GPS devices allow connection to *Bluetooth* audio devices. Consult your GPS User Manual for more information.
- After pairing, you may need to tap to connect the scala rider.

4.2 MAKING AND RECEIVING PHONE CALLS

Answer a call	Tap or say any word loudly to answer by VOX
Reject a call	Remain silent for 15 seconds, or press and hold for 2 seconds
End a call	Tap
Voice Dial* (if supported by mobile phone)	Tap and simultaneously and follow the prompt from the mobile
Redial*	Press and for 2 seconds

*This feature is not available during mobile calls

4.3 LISTENING TO MUSIC VIA A2DP

Available only on compatible <i>Bluetooth</i> audio sources	
Play	In Standby, tap
Pause/Stop	Press for 2 seconds
Next Track	With music ON, tap
Previous Track*	With music ON, double tap

*With some phones you may need to repeat this action

TROUBLESHOOTING

5

Reboot	If your scala rider stops responding, reset it by turning it off and then on again (press for 2 seconds).
Reset Pairing (Deletes paired device)	1. In Standby, press for 5 secs until LED flashes RED/BLUE . 2. Press for 2 seconds until LED flashes 5 times in PURPLE .
Unresponsive Device	Please connect to your charging cable for 30 seconds to allow the device to reset.

CONTACT & SUPPORT

6



cardosystems.com



support@cardosystems.com



USA and Canada: 1-800-488-0363
International: +49 89 450 36819