

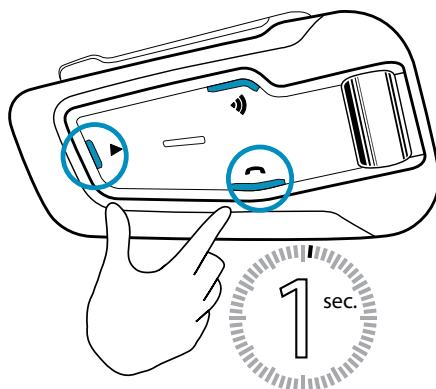

SMARTPACK POCKET GUIDE



On/ Off



Volume Up

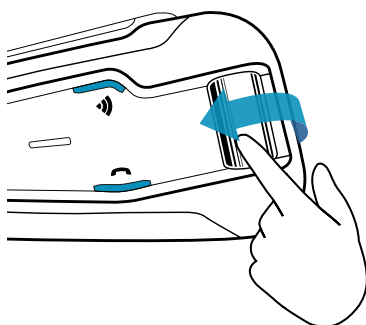

Volume Down



Mute/ Unmute

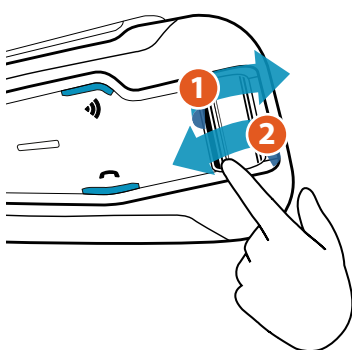

Stop / Pause

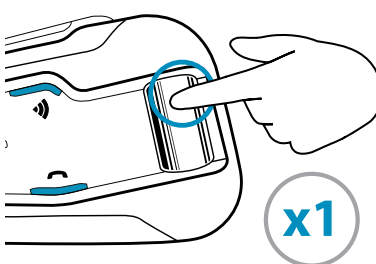

Use while charging

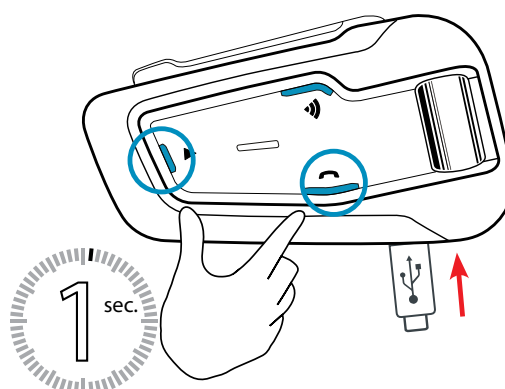
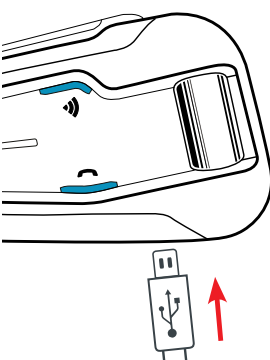



1

Initiate Pairing

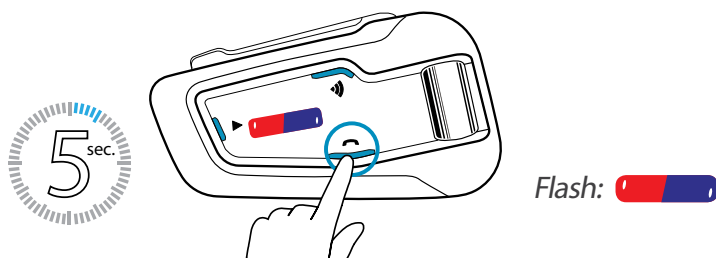

2

Search for Bluetooth devices



END

Paired successfully

Flash:

Cancel Pairing

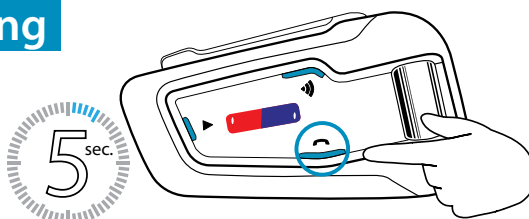



Add a 2nd Phone / GPS

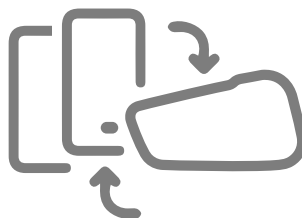

1

Initiate Pairing

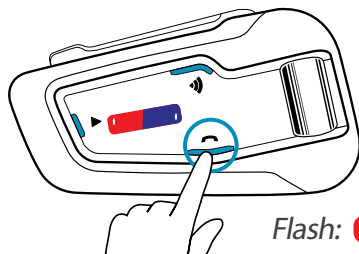

Flash:

2

Switch to channel 2

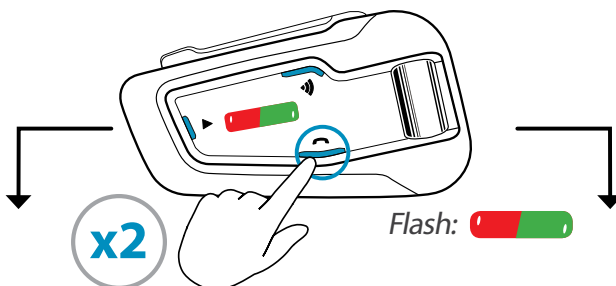

Flash:

3

Pair Phone

Search for
Bluetooth
devices

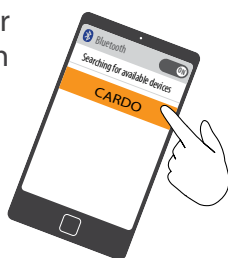

3

Pair GPS

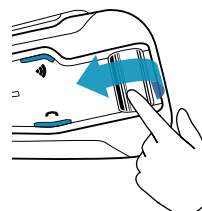

4

Search for
Bluetooth
devices



END

Paired successfully

Flash:

Cancel Pairing

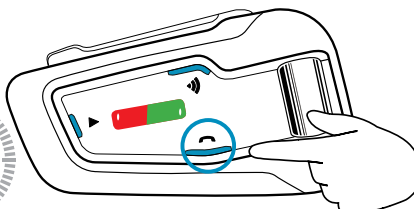



Answer a Call

x1

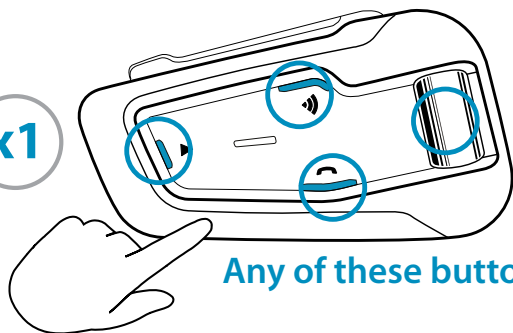

Any of these buttons

or



Ignore a Call

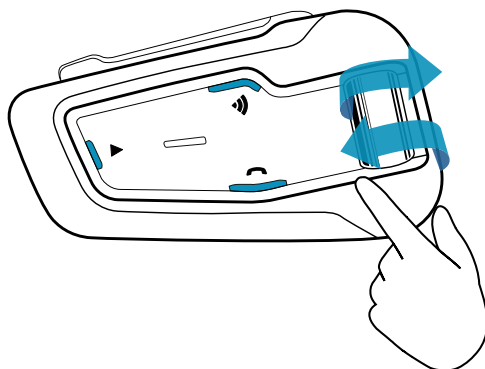

Reject a Call

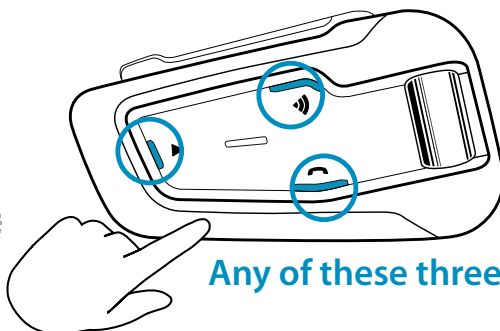

Any of these three buttons



End a Call

x1



Any of these three buttons



Voice Dial

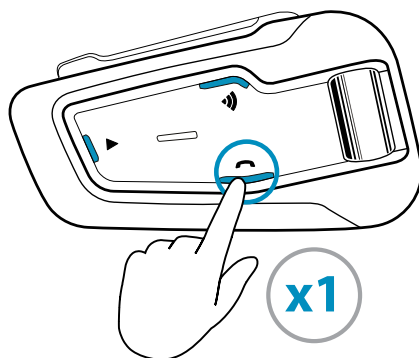

Redial

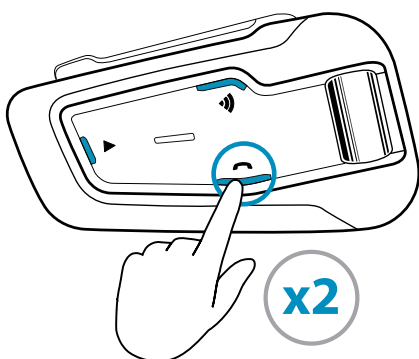

Speed Dial

Set via app

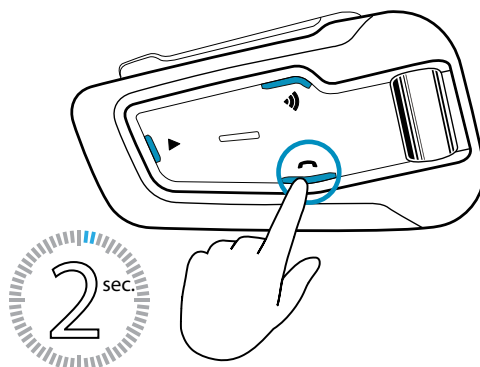

Share call with DMC group

Bridging active phone calls to the DMC group.

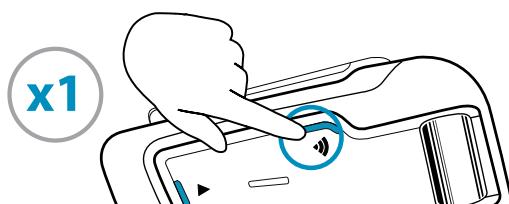

Start / Stop sharing call

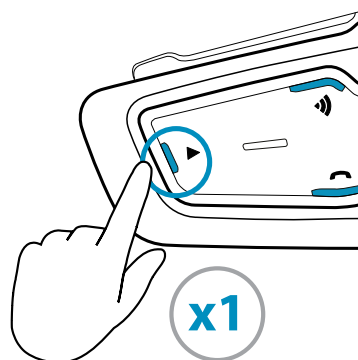
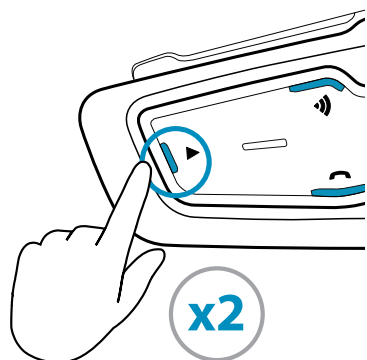
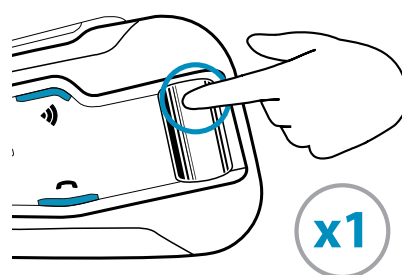
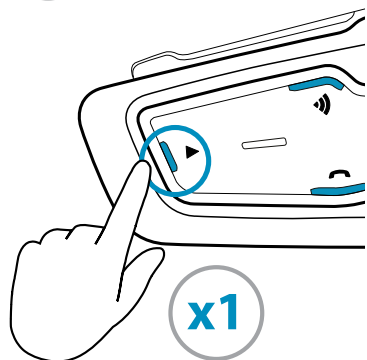

Sharing Audio

(When in Bluetooth mode)

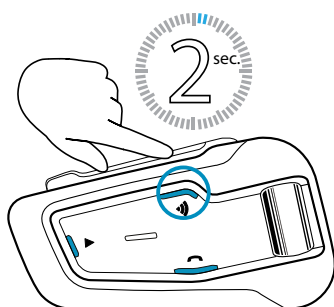

FM/ Music Toggle

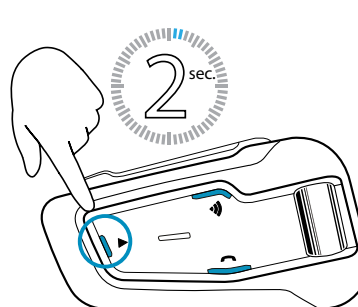

Audio - FM Radio



On

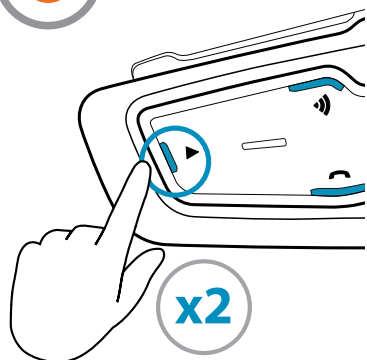

Off

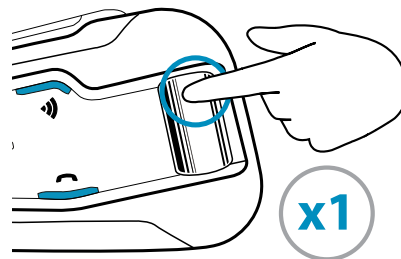

Previous

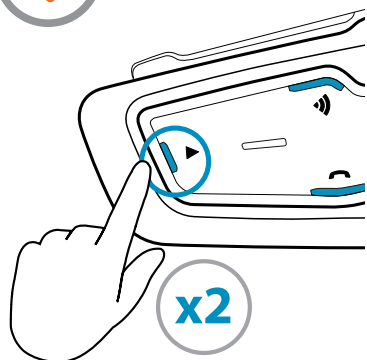

Next

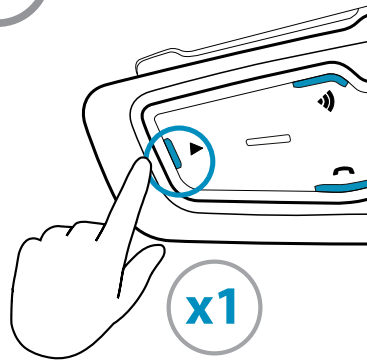

Auto Scan

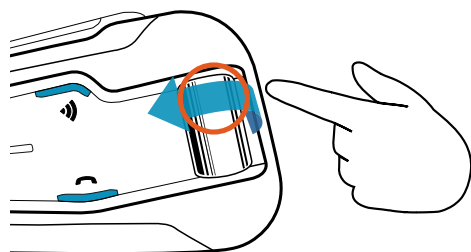

Press & Scroll

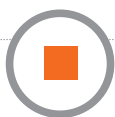

Stop Scan

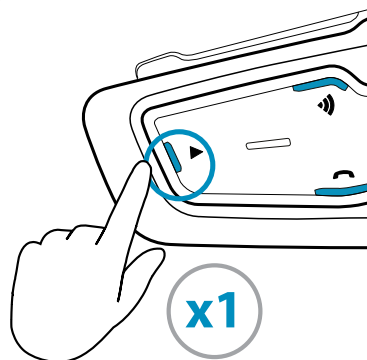

Sharing Audio

(When in Bluetooth mode)

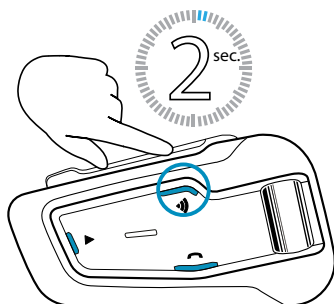

FM/ Music Toggle

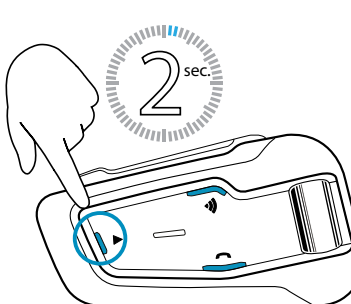



Verify you are in  DMC Mode Flash: 

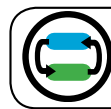

Bluetooth / DMC
Change Intercom Mode



Create a new DMC Group

1

Admin + all group members:

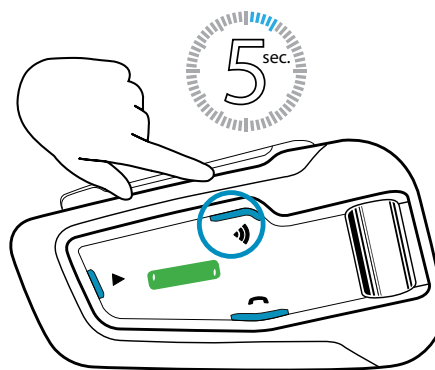

Rapid Flash: 

2

THEN ONLY ONE group admin

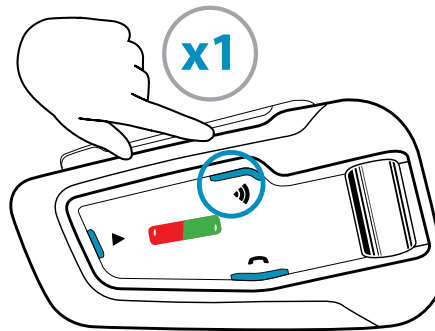

Flash: 

Grouped successfully Flash: 

Cancel Grouping

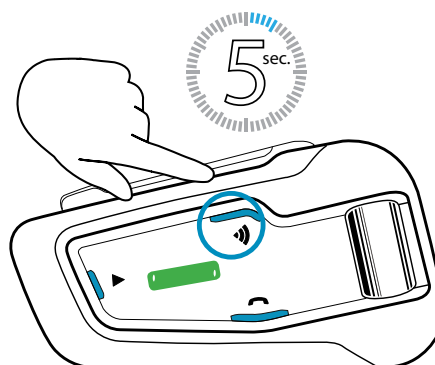



Verify you are in  DMC Mode Flash: 

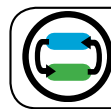

Bluetooth / DMC
Change Intercom Mode



Join an existing DMC Group

1

Admin + new member ONLY

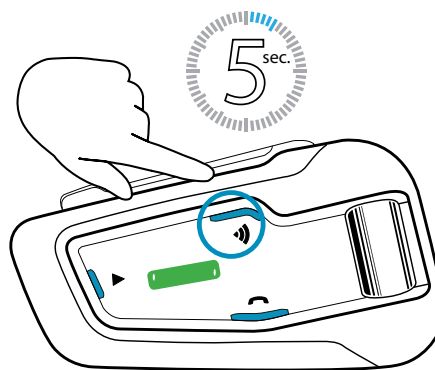

Rapid Flash: 

2

THEN ONLY ONE group admin

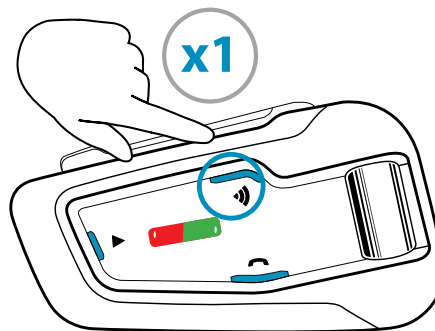

Flash: 

Grouped successfully Flash: 

Cancel Grouping

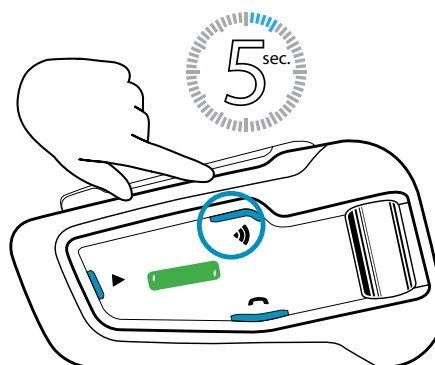



Verify you are in  DMC Mode Flash: 



Bluetooth / DMC
Change Intercom Mode



Talking - always on



Mute Group



Unmute Group

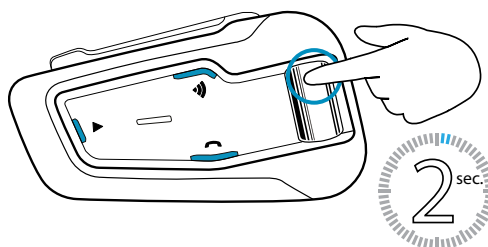

Bridge (add) a non-DMC passenger

1

First, verify that passenger is paired via Bluetooth.
(see 2-way Bluetooth intercom pairing)

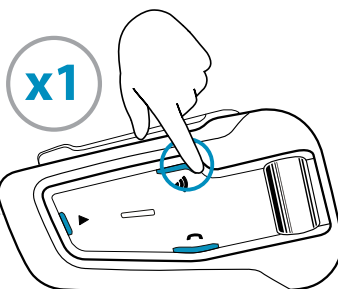

2

Start / Stop bridging

Private Chat

Chat privately with one of the group members

1

Choose member for private chat
via Mobile App



2

Start / Stop chat

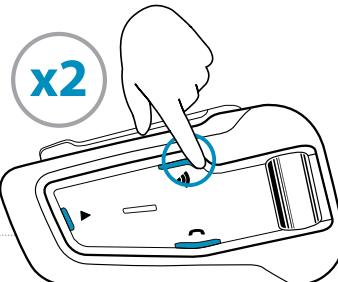



1

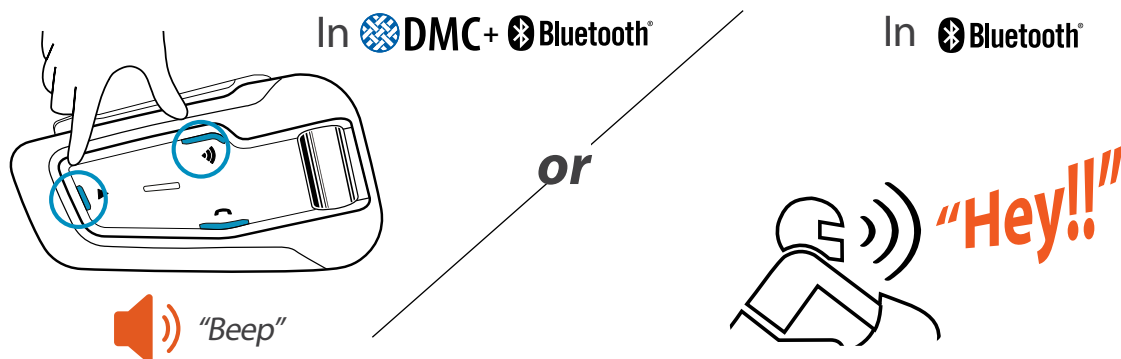

2

Say preferred voice command



or

Say "command list",
Select desired command



3

Command is implemented



Verify you are in  **Bluetooth Mode** Flash: 



2-way pairing

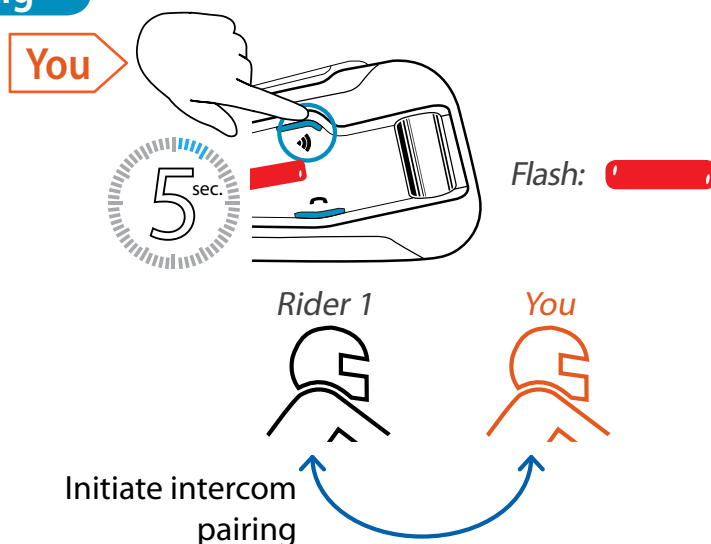

Adding 3rd rider

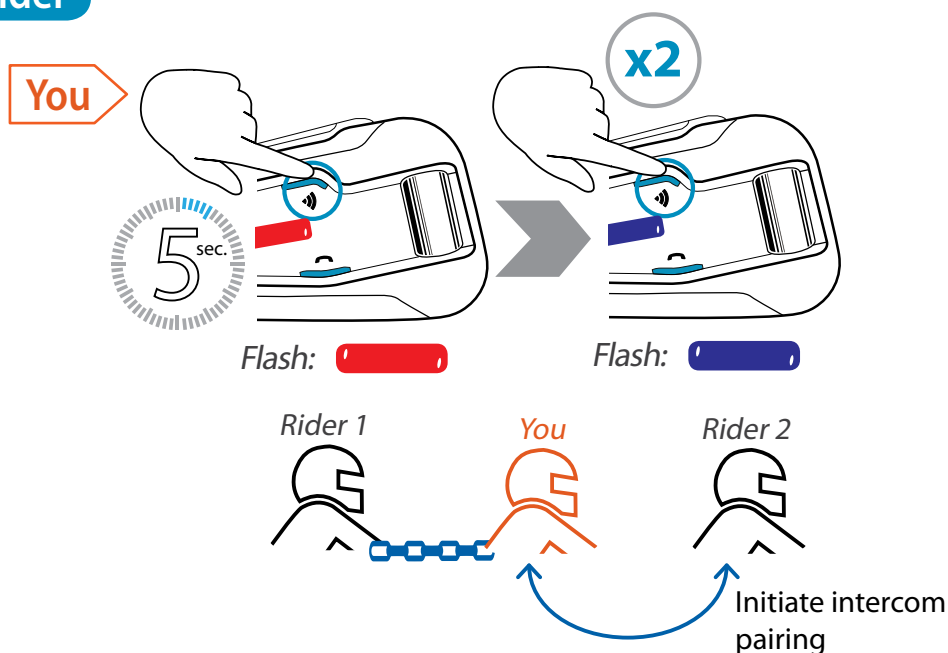

Adding 4th rider

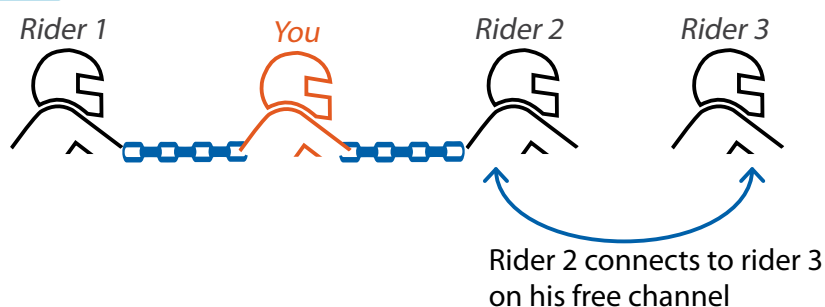



Verify you are in  **Bluetooth Mode** Flash: 

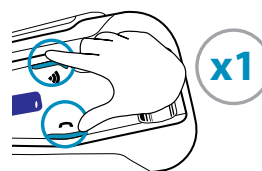
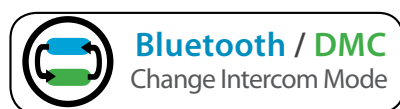

2-way pairing

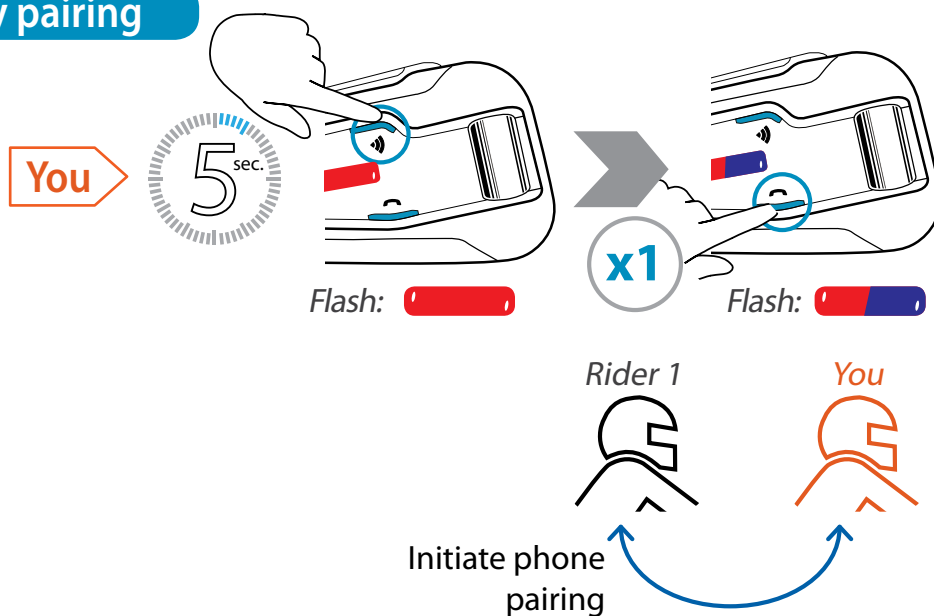

Adding 3rd rider

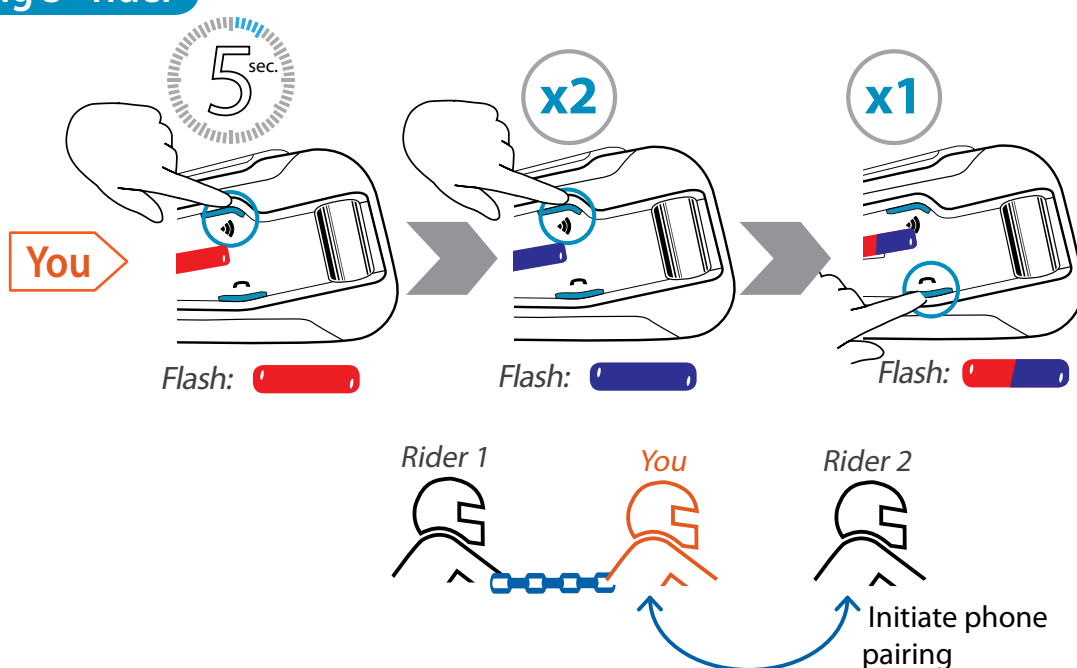

Adding 4th rider

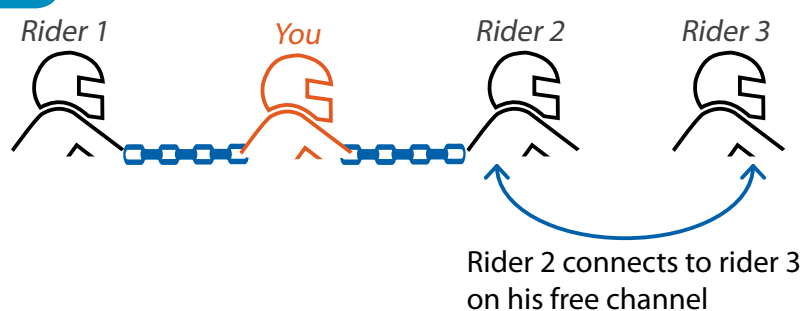



Start / End / Add conversation with Rider 1

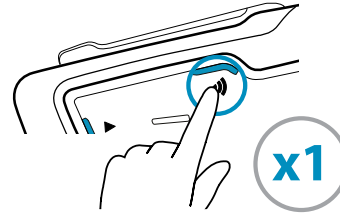

Start / End /Add conversation with Rider 2

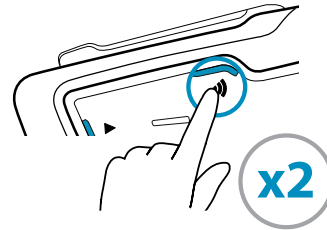

Initiating 4 way Bluetooth Intercom Conference

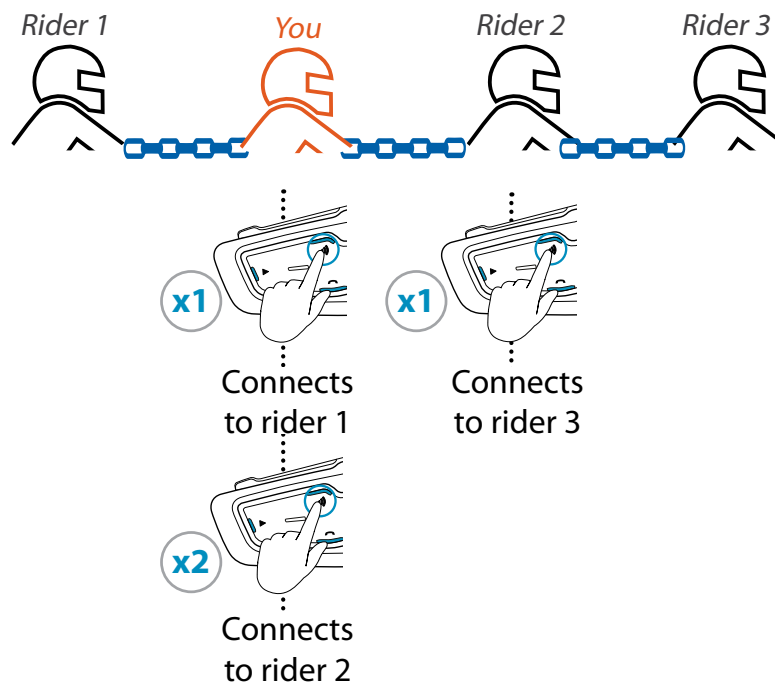

Factory Reset

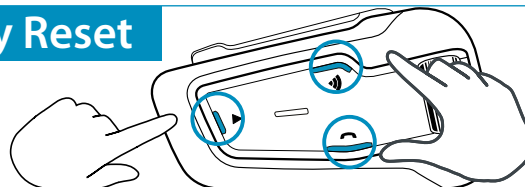

Flash x5:

For a full version of the manual, please visit:
cardosystems.com/product-manuals

Register your device on the **Cardo Community**:
cardosystems.com/cardo-community/

- Receive software update
 - Customize device
 - and more
-

Cardo Mobile App

- For easy configuration
- Remote control operation
- On-the-go setting customization
- Managing DMC groups



Ride Safe